

TECHNICAL DATA
 DONNEES TECHNIQUES
 DATI TECNICI

PERFORMANCES RANGE - CHAMPS DE PERFORMANCES - CAMPO DI PRESTAZIONE

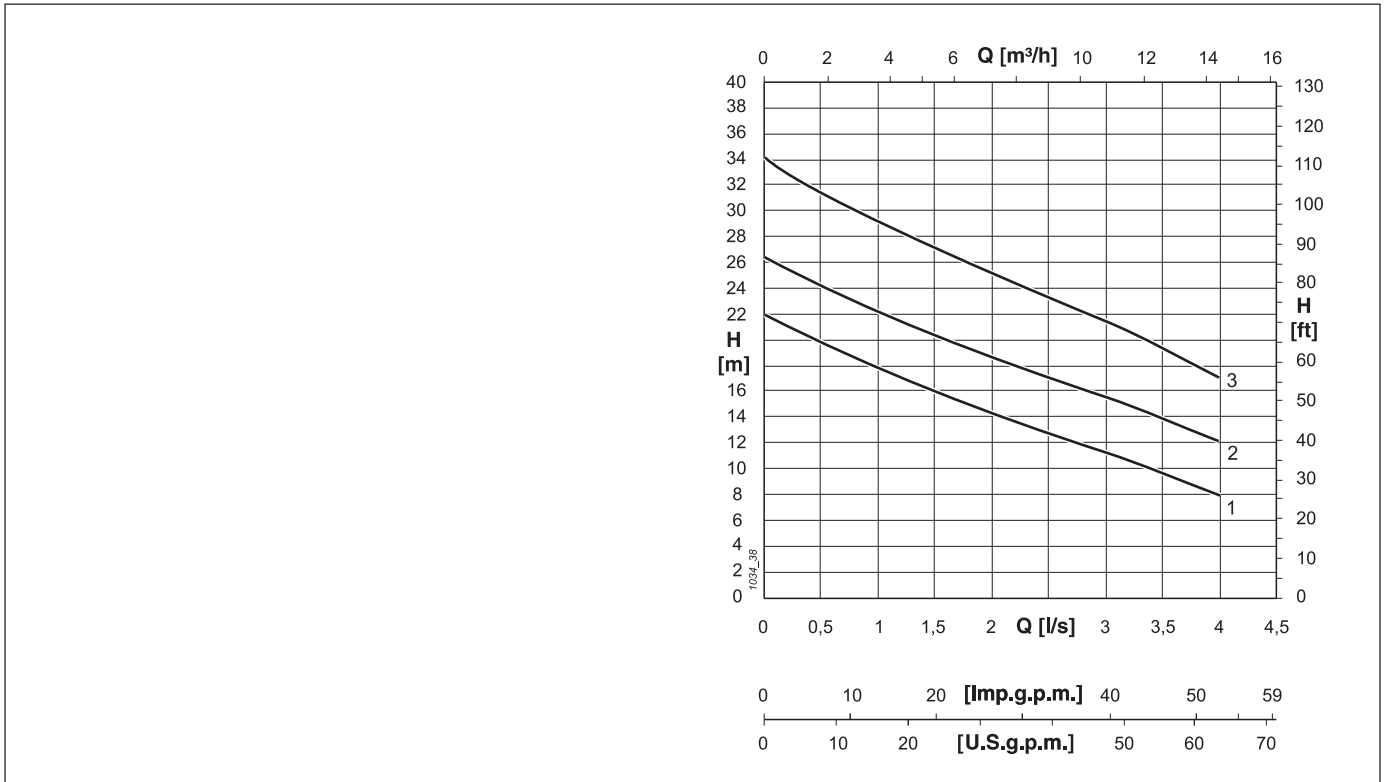

OPERATING DATA - CARACTERISTIQUES DE FONCTIONNEMENT - CARATTERISTICHE DI FUNZIONAMENTO

Electric pump type Electropompe type Elettropompa tipo	Curve Courbe Curva	Motor rating Puissance moteur Potenza motore N°	Delivery Refoulement Mandata DN	Capacity - Debit - Portata ... $\frac{[l/s]}{[m^3/h]}$								
				0	0,5	1	1,5	2	2,5	3	3,5	4
				0	1,8	3,6	5,4	7,2	9	10,8	12,6	14,4
				Head - Hauteur - Prevalenza ... [m]								
MAT11M2	1	1,1	G 2"	22	19,7	17,7	15,9	14,3	12,8	11,3	9,7	7,8
MAT11T2												
MAT16M2	2	1,6		26,4	24,1	22,1	20,4	18,6	17,1	15,6	14	12,1
MAT16T2												
MAT22T2	3	2,2		34,2	31,5	29,1	27	25	23,3	21,6	19,6	17

NOTES - NOTES - NOTE

P₂ = Power rated by the motor - Puissance restituée par le moteur - Potenza resa dal motore

Performance tolerance as per UNI/ISO 9906 grade 3B

Tolérances sur les performances selon normes UNI/ISO 9906 grade 3B

Tolleranze sulle prestazioni secondo norme UNI/ISO 9906 grado 3B.

TECHNICAL DATA
DONNEES TECHNIQUES
DATI TECNICI

OVERALL DIMENSIONS AND WEIGHTS - DIMENSIONS ET POIDS - DIMENSIONI DI INGOMBRO E PESI

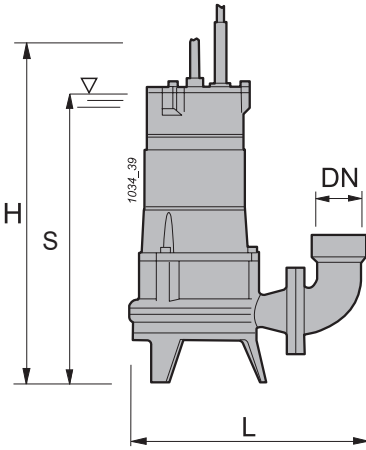

MAT

Type Type Tipo	DN	L	H	S	Cable- Cableu Cavo	Weight Poids Peso
					H07RN8-F	
					(1)	[kg]
MAT11M2	G 2"	326	463	375	4 x 1,5 x 5	30
MAT11T2						
MAT16M2		373	540	440	4 x 2,5 x 5	35
MAT16T2						
MAT22T2						

TECHNICAL FEATURES - CARACTERISTIQUES TECHNIQUES - CARATTERISTICHE TECNICHE

Electric pump type Electropompe type Elettropompa tipo	Curve Courbe Curva	Delivery Refoulement Mandata	Motor - Moteur - Motore						
			N°	DN	Power Puissance Potenza		Voltage Tension Tensione	Rated current Intensité Assorbimento	poles nr. n. pôles n. poli
					P ₁	P ₂			
					[kW]	[V]	[A]		
MAT11M2	1	G 2"	1,5	1,1	230	6,8	2		
MAT11T2			1,7		230(3) - 400	5,2 - 3			
MAT16M2	2		2,3	1,6	230	11			
MAT16T2			2,2		230(3) - 400	6,8 - 3,9			
MAT22T2	3		2,9	2,2	230(3) - 400	8,7 - 5			

NOTES - NOTES - NOTE

- (1) Number of cable wires x Section of the wires [mm²] x Length of the cable [m] - *Nombre conducteurs x Section conducteurs [mm²] x Longueur câble [m]*.
Numero di conduttori x Sezione dei conduttori [mm²] x Lunghezza del cavo [m].
- (2) Rated current absorbed at the corresponding voltage - *Intensité absorbée à la tension correspondante* - **Corrente nominale assorbita alla corrispondente tensione**
- (3) 400 V standard, 230 V by on demand - *400 V standard, 230 V sur demande* - **400 V standard, 230 V su richiesta**
- P₁ = Power absorbed by the motor - *Puissance absorbée aux bornes du moteur* - **Potenza assorbita motore.**
- P₂ = Power rated by the motor - *Puissance restituée par le moteur.* - **Potenza resa dal motore.**

ACCESSORIES
ACCESSOIRES
ACCESSORI

PERMANENT INSTALLATION WITH DUCK-FOOT PEDESTAL FOR AUTOMATIC COUPLING - INSTALLATION FIXE AVEC PIE D'ASSISE POUR ACCOUPLEMENT AUTOMATIQUE
BASAMENTO PER ACCOPIAMENTO AUTOMATICO

BAM 3/4"

For pumps type:
Pour électropompe type:
Per elettropompe tipo:

- MAV07 I = 387
- MAV11M4 I = 414
- MAV11T4 I = 414
- MAV11M2 I = 387
- MAV11T2 I = 387

- MAV15T2 I = 414

- MAM07 I = 387
- MAM11 I = 387
- MAM15 I = 414
- MXT I = 390

- MAT11 I = 407
- MAT16 I = 464
- MAT22 I = 464

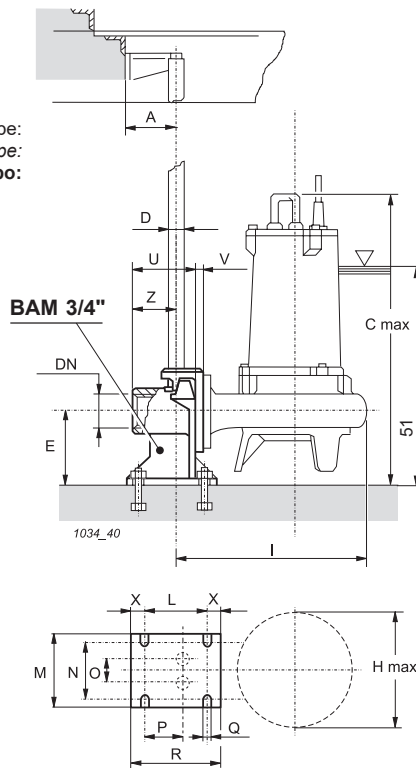

BAMF/E 2"

For pumps type:
Pour électropompe type:
Per elettropompe tipo:

- MAV15T4 I = 466

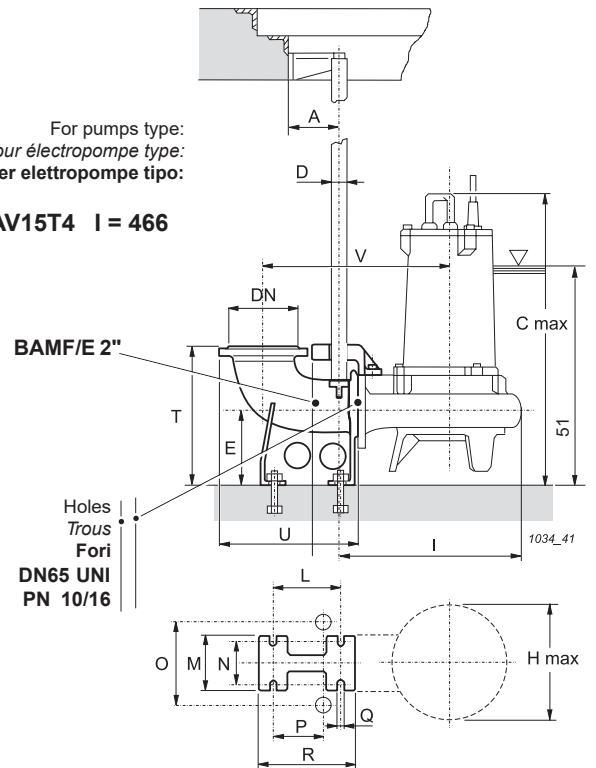

Type Type Tipo	DN	A	C max	D	E	H max	I max	L	M	N	O	P	Q	R	T	U	V	Z	X
		[mm]																	
BAM 3/4"	G 2"	85	580	ø 3/4"	130	240	320	110	125	110	38	75	15	150	-	102	25	85	20
BAMF/E 2"	80 UNI PN10	102	585	ø 2"	160	290	-	156	135	110	185	125	18	230	280	320	420	-	-

The following are also available:
Anchoring bolts,
level regulators
and Electric panels

Accessoires supplémentaires:
Tire-fond,
Régulateurs de niveau
et Coffrets électriques

Sono inoltre disponibili:
Tirafondi,
Regolatori di livello e
Quadri elettrici

<p>Type Type Tipo</p>																				
<p>Parts Nomenclature Nomenclatura</p>	<table border="1" style="width: 100%; border-collapse: collapse;"> <thead> <tr> <th>A ø</th> <th>B [m]</th> <th>Type Type Tipo</th> <th>Weight Poids Peso [kg]</th> <th>BAM 3/4"</th> <th>BAMF/E 2"</th> </tr> </thead> <tbody> <tr> <td>2"</td> <td>6</td> <td>TUB 2"</td> <td>20</td> <td style="text-align: center;">-</td> <td style="text-align: center;">●</td> </tr> <tr> <td>3/4"</td> <td>6</td> <td>TUB 3/4"</td> <td>9,5</td> <td style="text-align: center;">●</td> <td style="text-align: center;">-</td> </tr> </tbody> </table>	A ø	B [m]	Type Type Tipo	Weight Poids Peso [kg]	BAM 3/4"	BAMF/E 2"	2"	6	TUB 2"	20	-	●	3/4"	6	TUB 3/4"	9,5	●	-	<p>CAT D.6 0,7 kg/m</p> <p>GRI D.8 0,07 kg</p> <p>Max load Portée maxi. 140 kg Portata max.</p>
A ø	B [m]	Type Type Tipo	Weight Poids Peso [kg]	BAM 3/4"	BAMF/E 2"															
2"	6	TUB 2"	20	-	●															
3/4"	6	TUB 3/4"	9,5	●	-															
<p>Material Matériel Materiale</p>	<p>Rail pipes Barres de guidage Tubi guida</p>	<p>Chain and Shackle Chaîne et Manille Catena e Grillo</p>																		
	<p>Dipped galvanized steel (1) Acier galvanisé à chaud (1) Acciaio zincato a caldo (1)</p>	<p>Dipped galvanized steel (1) Acier galvanisé à chaud (1) Acciaio zincato a caldo (1)</p>																		

(1) = On demand: stainless steel - Sur demande: acier inox - Su richiesta: acciaio inox